

User-friendly

A couple in their mid-sixties want a new kitchen that looks super sleek and, just as importantly, won't require them to have to stoop down for the things they need. Connaught Kitchens and Neil Lerner Kitchen Design devise designs to keep them on their toes

Report: Abby Tew. Sketch photography: Gary Hamill

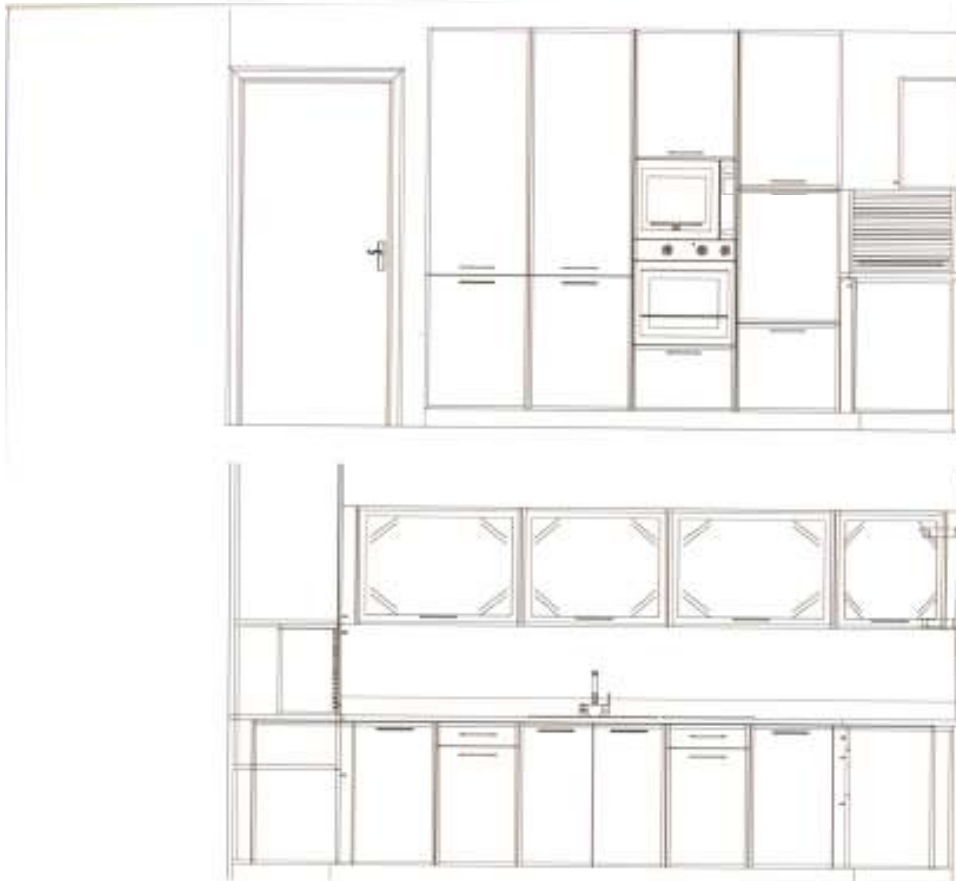

NEIL LERNER



Neil Lerner would move the boiler to the cellar and remove the chimney breast altogether to free up space. This would not be difficult as RSJs (reinforced steel joists) would support the ceiling

Neil has specified furniture by Häcker finished with a light oak veneer and a Corian worktop with an integrated sink in a contrasting dark shade. He would put all the tall units on the left-hand side of the room, starting with a fridge-freezer, then a larder unit, an oven stack containing a single oven with a microwave above, then a dishwasher at mid-height. "You forget how much bending down you have to do to load and unload dishwashers, so for these clients, it would make sense to raise it," says Neil. Finally, in the corner above the worktop he'd use a tambour cupboard.

Along the back wall under the counter he has specified a magic corner unit at both ends, with a single pull-out base storage unit, a double unit under the sink with storage for cleaning materials and a pull-out 32-litre bin in between. He has put diffused glass-fronted cupboards along the wall above the sink, with lift-up doors. "They would also reflect light around the room," he says.

Neil has put a gas hob and extractor in the middle of the worktop along the right-hand wall, which has deep pull-out drawer units below, and underlit glass shelves in a stainless steel frame on the walls either side of the hob. "I've kept the right-hand wall fairly free to contrast with the facing wall, which features the tall units," he says.

The worktop would include a low up-stand along the back and right-hand walls, which would have a floating glass splashback above. Ceramic tile flooring would be in a limestone or sandstone colour.

Neil's design is very modern, but the light oak veneer makes it look warm and natural. "You also have a lot of storage and preparation space and because the base units are all pull-out, you don't have to stoop."

Neil Lerner Kitchen Design 020 7034 4920 or www.neillemer.com



THE SPECIFICATIONS



Häcker Oak Diamond veneer furniture	£12,338
Siemens appliances	£4113
Corian worktops and sink	£5288
Glass splashback	£2115
Flooring	£1175
Lighting	£588
Dry-fit installation	£2115

Total	£27,732
--------------	----------------